

Replacement Parts List Gas Char Broiler - Model 41



*Counter Top Model - 41C
Closed Front*



*Floor Model - 41F
Open Front*

Installation and Service Manual - 8448-24
Date Code - September 1959
(Supersedes EMB28 Replacement Parts
List for Open Hearth Broiler Model 41)

Items listed are replacement parts for the current Model 41 EmberGlo® Broiler.

Model 41 first construction September 1959. Dual pilot model with ten burners.

<i>Models</i>	<i>Description</i>	<i>BOMs</i>
<i>Natural Gas</i>		
41C	Open Front - Counter	5030102
41C	Closed Front - Counter	5030100
41F	Open Front - Floor	5030201
41F	Closed Front - Floor	5030200
<i>Propane Gas</i>		
41C	Open Front - Counter	5130102
41C	Closed Front - Counter	5130101
41F	Open Front - Floor	5130202
41F	Closed Front - Floor	5130201



EmberGlo®

EmberGlo
A Div of Midco® International Inc.
4140 West Victoria Street
Chicago, Illinois 60646
toll free 866.705.0515
tel 773.604.8700
fax 866.705.0514
web www.emberglo.com
e-mail sales@emberglo.com



AVOID ERROR IN PARTS SELECTION. When ordering use complete MIDCO Part Number and Description. Furnish Burner Model Number, Bill of Material Number and Serial Number (if available) from the specification plate found on the product.

IMPORTANT: Availability of parts as well as specifications are subject to change without notice. Please consult factory for item availability.



As an ISO 9001:2008 certified company, we proudly design, manufacture and assemble our products in Chicago, Illinois, USA.

Quality Designed for Proven Performance

822
8472 23
Printed in USA

Exploded View - Gas Broiler Model 41 Parts List

Item Part #	Description	Qty
1 * 4585-50	8-1/4" L Ceramic Barbrig - 5 Pack ¹	13Pcks
2 4630-02	31-41 Marinite (uses 2)	2
3 * 4585-60	Support Bricks for Barbriqs OR ceramic rods - 4 per Pack ²	4 Pcks
4 4629-20	Front And Back Wall Block Model 31-414	
5 4717-10	Filler Block Front & Back Model 41	4
6 4838-00	41 Floor Brick	4
7A 4574-42	Stamped Orifice Propane Model 31-41 # 65 (.035") Drill	10
7B 4574-44	Stamped Orifice Natural Model 31-41 # 54 (.055") Drill	10
8A 4824-02	41 Left Manifold	1
8B 4824-01	41 Right Manifold	1
9 4518-07	Broiler Pilot Tube	2
10A 4825-03R	Valve Stem Extension	2
10B 4708-10	Valve Stem Assembly Kit	1
11 8401-03	1/8" Pilot Gas Valve	1
12 4507-15	Broiler Pilot Burner	2
13 4507-12	Broiler Burner	8
14A 8416-35	1/2 Regulator – Natural	1
14B 8416-36	1/2 Regulator – Propane	1
15 4802-20	1/2" Ball Valve Assm	1
16 4508-10	Burner Tile Model 31-41	6

Item Part #	Description	Qty
17 8435-04R	Flaretrol Motor	1
18 4569-00	7-1/8" X 1.0" CW Blower Wheel	1
Not Shown		
1403-70R	Power Cord 120 v	
4508-82	Propane to Natural Conversion Kit	
4508-92	Natural to Propane conversion Kit	
* 4576-20	Rods - 12 per Pack ⁴	6 Pcks
* 4577-01	Briquettes - 20# per Pack ³	3 Pcks
4581-50	Main Valve Knob	2
4720-10	Stainless Steel Foot - Countertop Gas Broilers	
4842-00	Cooking Grill Grate	1
8423-01R	Flaretrol Switch	1
8445-03	Pilot Knob	1
8450-12	Adjustable Leg floor model (41F)	4

Accessories / Options - Not Shown

2070701	Veggie/Seafood Grate for Broiler Model 41
1420-39	Gas Broiler Grill Brush - all Gas Broiler Models
4508-52	41 Kabob Broiler Conversion Kit from Regular Broiler to a (includes 10 Skewers)
2060170	41 Gas Broiler Splash Guard Set SS

- * 1 **Barbrig** - Item # **4585-50** - 1" x 1" x 8-1/4" - Sold in 5-Packs ONLY
Models 41 requires 13 Packs for a complete hearth replacement
- 2 **Support Bricks**- Item # **4585-60** - Sold in 4-Packs ONLY
Model 41 requires 4 Packs for a complete hearth replacement.
Used with Barbriqs or Ceramic Rods
- 3 **Briquettes** - Item # **4577-01** - 1" x 1" x 2" - Sold in 20 lb. Carton
quantities ONLY Model 41 requires 45 lb. for a complete hearth
replacement - 3 Cartons recommended
- 4 **Ceramic Rods** - Item # **4576-20** -
1/2" diameter Rods by 8-1/2" - Sold in 12-Packs ONLY
Model 41 requires 6 Packs for a complete hearth replacement.
Used with Briquettes

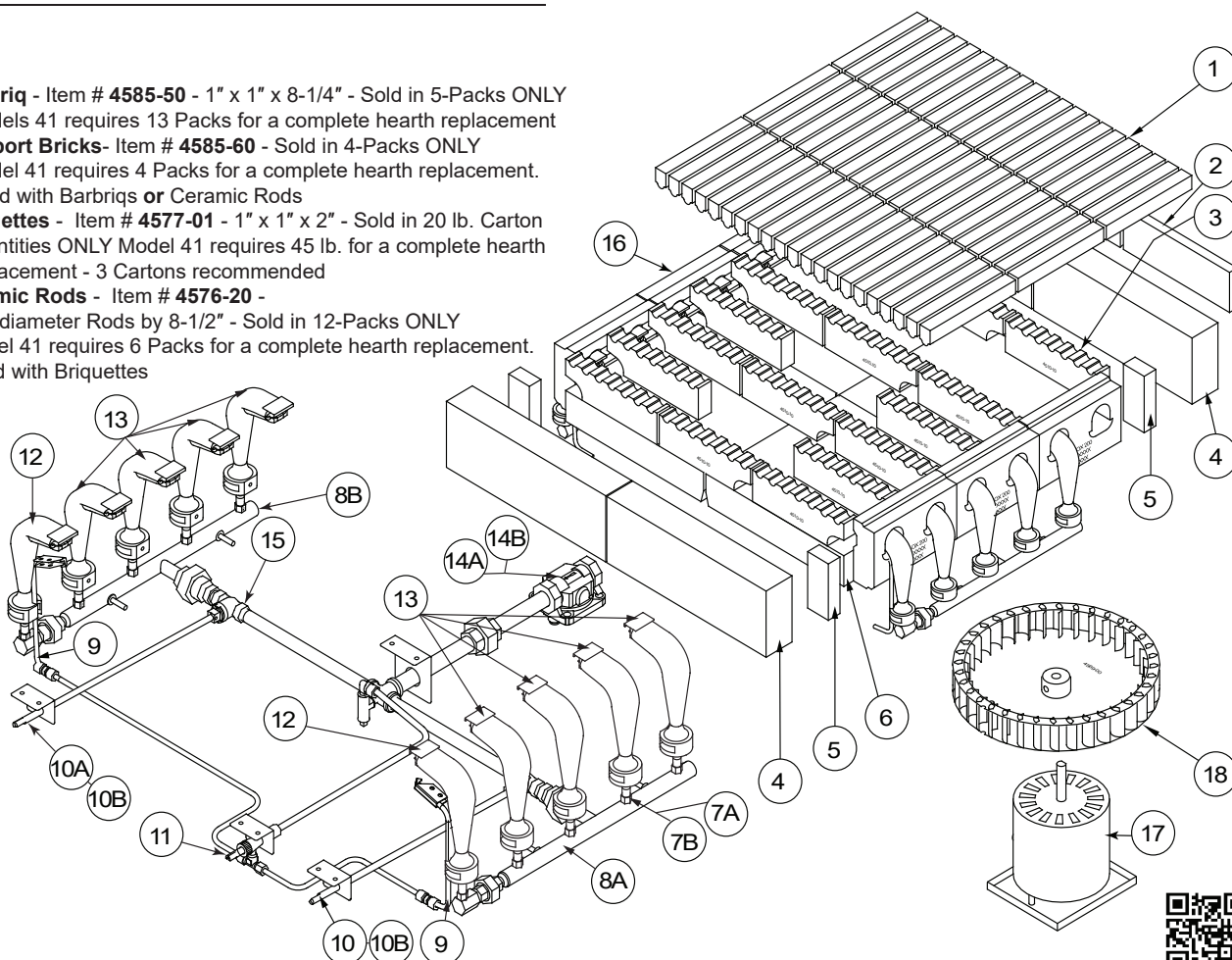

As an ISO 9001:2008 certified company, we proudly design, manufacture and assemble our products in Chicago, Illinois, USA.

EmberGlo - A Division of Midco International - 4140 West Victoria Street - Chicago, Illinois 60646

toll free: 866 705 0515 - tel: 773.604.8700 - fax: 866.580.8700 - web: www.emberglo.com - e-mail: sales@emberglo.com

822
8472 23
Printed in USA